



LumiGuardian Solar Security Trailer

User Manual

Foreword

General

This manual provides an overview of the setup and transportation of the LumiGuardian solar trailer. Please read it carefully and store it safely for future reference.

Revision History

Revision	Content	Release Date
1	Initial Release	July 2025

Privacy Protection Notice

As a device user or data controller, you may collect personal data such as facial images, fingerprints, and license plate numbers. It's essential to comply with local privacy laws to safeguard individuals' rights. This includes providing clear identification of surveillance areas and necessary contact information.

Disclaimer

While we strive to ensure the accuracy and completeness of this document, we do not provide any formal guarantees. The use and results derived from this document are the sole responsibility of the user. We also reserve the right to modify its contents without prior notice.

About the Manual

- This manual is for reference only and may have minor discrepancies with the actual product.
- We are not liable for damages resulting from improper operation contrary to this manual.
- The manual will be updated to align with the latest laws and regulations. For more information, refer to the paper manual, scan the QR code or visit our official website. Minor differences may exist between electronic and paper versions.
- All designs and specifications are subject to change without notice. Product updates may lead to discrepancies between the manual and the actual product. Contact customer service for the latest information and documentation.
- There may be errors or inaccuracies in the descriptions of functions, operations, and technical data. We reserve the right of final interpretation in case of questions or disputes.
- If the manual cannot be opened, please update your reader software or try another compatible reader.
- All trademarks and company names mentioned are the properties of their respective owners.
- For assistance, visit our website or contact your supplier or customer service.
- We reserve the right of final interpretation in case of questions or disputes.

Safety Instructions

The following symbols might appear in the manual.



Symbol	Definition
	Indicates a risk hazard that, if not avoided, may result in death, injury, property damage, data loss, decreased performance, or unpredictable outcomes.
	Offers methods to help you troubleshoot issues or save time.
	Provides more context and information.





Table of Contents

Foreword..... I

 General I

 Revision History I

Privacy Protection Notice I

Disclaimer I

About the Manual..... I

Safety Instructions I

About the LumiGuardian..... 1

How to Set Up the LumiGuardian for Use 1

How to Prepare the LumiGuardian for Transport 4

 Forklift Transport Guidelines 5

About the LumiGuardian

The LumiGuardian Solar Security Command Center is a state-of-the-art, mobile trailer that proactively prevents incidents before they occur. Powered by solar energy and advanced AI through seamless LumiCloud integration, it goes beyond post-incident forensic analysis. The LumiGuardian deters crime with flashing lights, deterrent floodlights, real-time alerts, and audio warnings.

How to Set Up the LumiGuardian for Use

Follow the steps below to set up the LumiGuardian for use. The steps correspond to area numbered on the diagram.

① Some of the instructions may vary based on the version of the trailer.

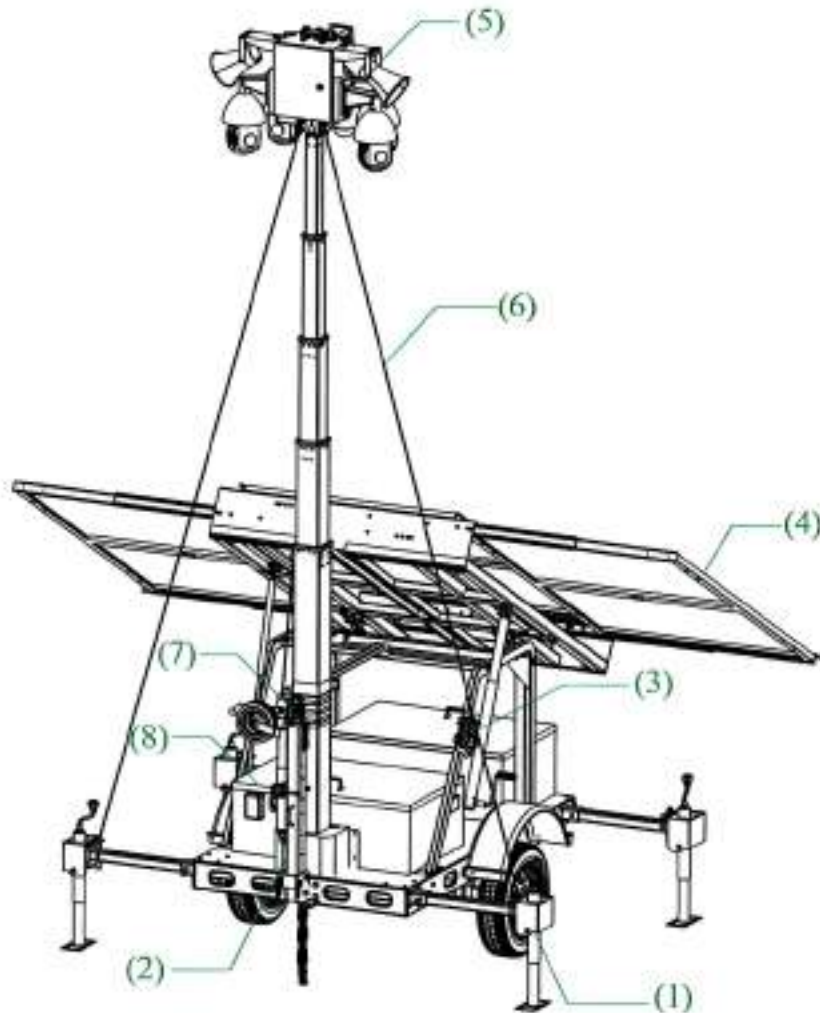

1. Pull the four corner supports outward to fully extend them.
2. Fold in the tow arm.
3. Turn the hand crank to adjust the angle of the solar panel. The panel should be positioned at an angle that allows maximum sunlight exposure.
4. Pull on the sides of the solar panel to fully extend it.
5. Follow the diagram below to install the control box and attach the cameras and speakers.

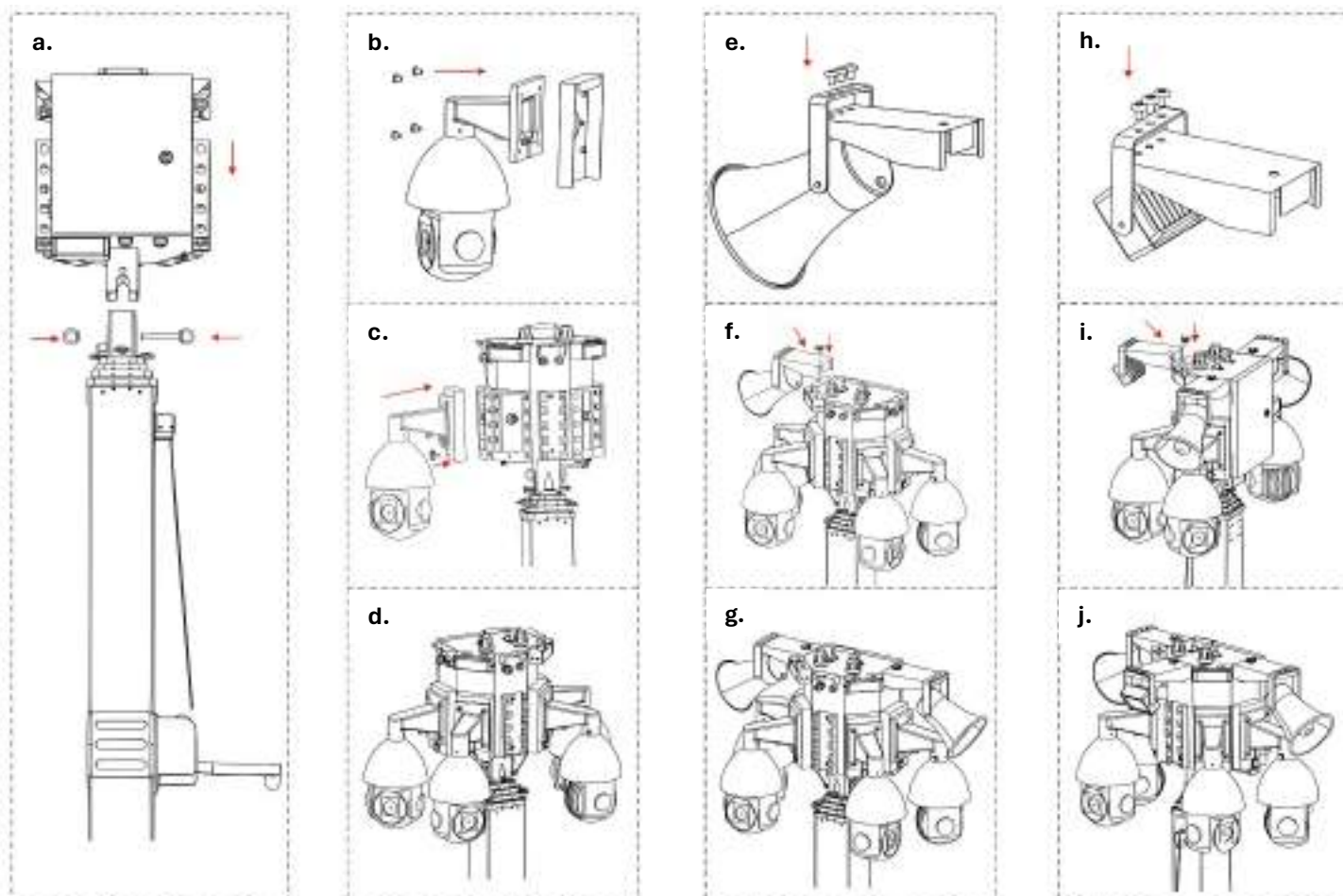

- a. Install the control box by pushing the box on top of the mast and securing with the o-ring bolt and nut.
 - b. Attach the camera and mounting bracket to the mounting plate with hex screws.
 - c. Install the camera onto the control box using the black knob screw.
 - d. Repeat steps (b) and (c) for all cameras.
 - e. Attach the speaker to the arm using hex screws.
 - f. Install the speaker onto the control box using the black knob screw.
 - g. Repeat steps (e) and (f) on the other side of the control box.
 - h. Mount the floodlight to the arm using hex screws.
 - ① The floodlight may ship pre-mounted. If so, skip this step.
 - i. Install the floodlight onto the control box using the black knob screw.
 - j. Repeat steps (h) and (i) on the other side.
6. Attach the steel cables using the carabiners. One end of the cable will attach to the corner support, while the other end will attach to the bottom of the control box. Repeat on each side of the trailer.
 7. Extend the mast of the trailer using the silver hand crank with the red handle. Stop when the red line appears.
 8. Open the electrical box using the small silver key from the storage box. Power on the trailer computer to verify the trailer computer is functioning properly. The diagram below shows the inside layout of the electrical box.

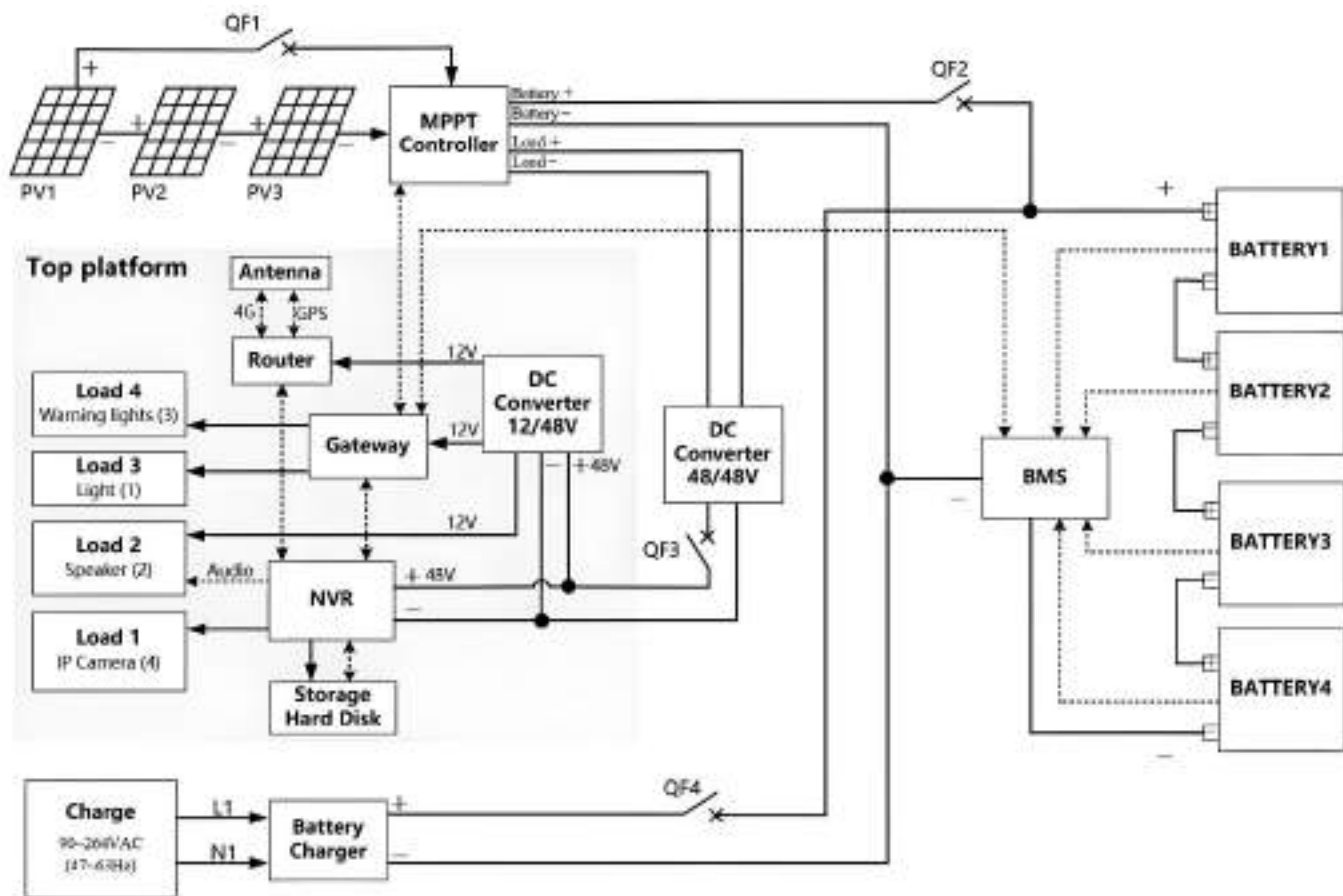

The trailer is now set up and ready to use.

How to Prepare the LumiGuardian for Transport

Follow the steps below to prepare the LumiGuardian trailer for transport. The steps correspond to area numbered on the diagram.

① Some of the instructions may vary based on the version of the trailer.

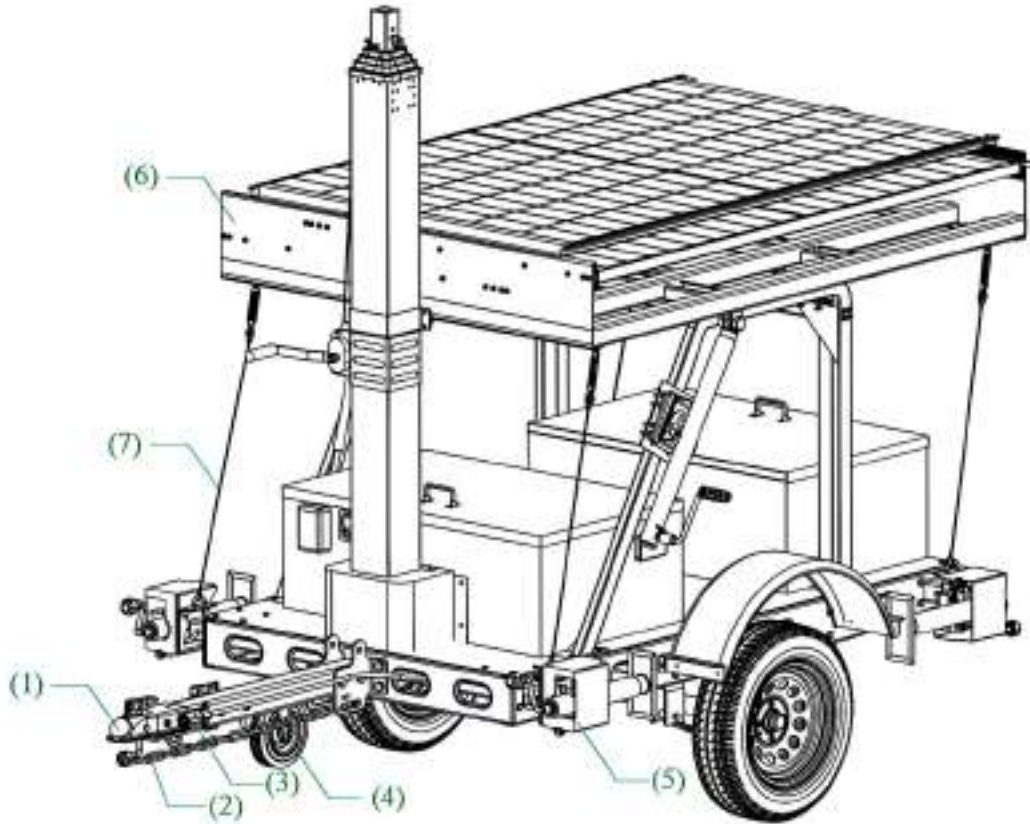

1. Pull out the trailer's tow arm and securely attach the ball connector.
2. Reattach the iron chain to the front connector.
3. Connect the signal line plug from the trailer to the transport vehicle or tractor.
4. Retract the leading wheel to reduce drag while transporting.
5. Pull in the four corner supports. Ensure the supports are evenly retracted to ensure proper balance.
6. Use the hand crank to retract the solar panel.
7. Use four steel wire ropes and carabiners to secure the solar panel to the four corner supports.

Forklift Transport Guidelines

Only lift the trailer from both sides or the front when using a forklift. This ensures maximum visibility and control. **Do not** lift from the rear of the trailer.

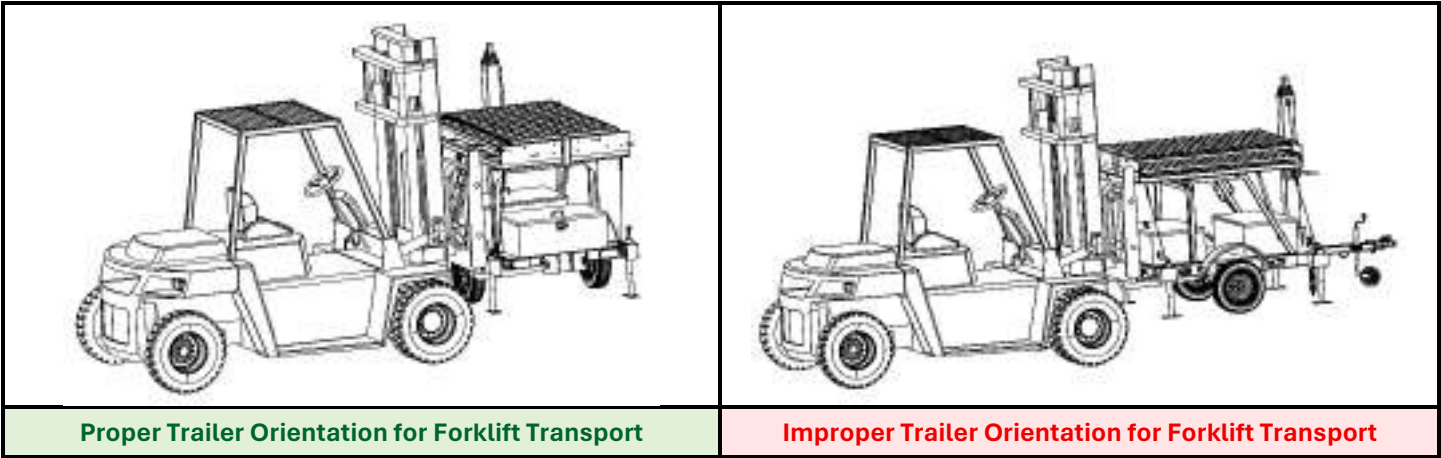

For more product information, a step-by-step walkthrough, or video walkthrough of the setup, visit the [Luminys Wiki page](#) or scan the QR codes below.



Scan for a step-by-step walkthrough of the LumiGuardian setup.

Scan for more product information.

Scan for a video walkthrough of the LumiGuardian setup.