

PCS-100



- 1-bay Mini Server
- Intel Core i5-6500TE, 8GB

► Specifications

Device

| | |
|--------------|--------|
| Product Type | Server |
|--------------|--------|

Hardware

| | |
|-----|----------------------|
| CPU | Intel Core i5-6500TE |
| RAM | 8GB |

Audio

| | |
|------------|-------------------------|
| Audio Type | 2-way, Mic-in, Line-out |
|------------|-------------------------|

Network

| | |
|---------------|--|
| Ethernet Port | Total ports: 2 port(s) Non-PoE: 2 port(s), Ethernet (1000 Base-T), RJ-45 connector |
|---------------|--|

System

| | |
|-------------------------|----------------|
| Server Operating System | Windows 10 IoT |
| USB | 6-Port USB 3.0 |

Storage

| | |
|--------------|--|
| System Drive | M.2 SSD, 256GB |
| Storage Bay | SATA, Max. 1 Disk(s) (without storage disks) |
| HDD Size | 3.5" |

Interface

| | |
|----------------------------|--------------------------------------|
| Serial Port | 2 x RS-232 |
| Audio Interface | 1/1, 3.5mm Phone Jack |
| External Storage Interface | eSATA |
| Expansion Slots Available | 1 x PCIe 3.0 (x16) |
| Local Access | USB keyboard & mouse |
| Local Display Interface | HDMI x 1, DVI x 1, Display Port x 1, |

General

| | |
|-----------------------|---|
| Power Source | AC 100-240V |
| Power Supply | 250W |
| Weight | 3279g (7.23lb) |
| Dimensions | (W x H x D): 255mm x 88mm x 230mm (10" x 3.5" x 9.1") |
| Bundled Accessories | Power cord, Universal power connector |
| Fan | Yes |
| Operating Temperature | 0°C ~ 40°C (32°F ~ 104°F) |
| Operating Humidity | 10% - 85% RH |
| Color | Black |
| Warranty | 3 Year(s) |

▶ Photo Indication

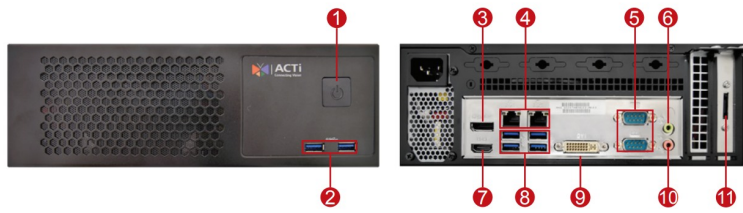

- 1 Power Button
- 2 USB 3.0 Port
- 3 Display Port
- 4 Ethernet Port
- 5 Serial Port
- 6 Audio Line-out
- 7 HDMI Port
- 8 USB 3.0 Port
- 9 DVI Port
- 10 Audio Mic-in
- 11 eSATA Port

▶ Dimension Diagram

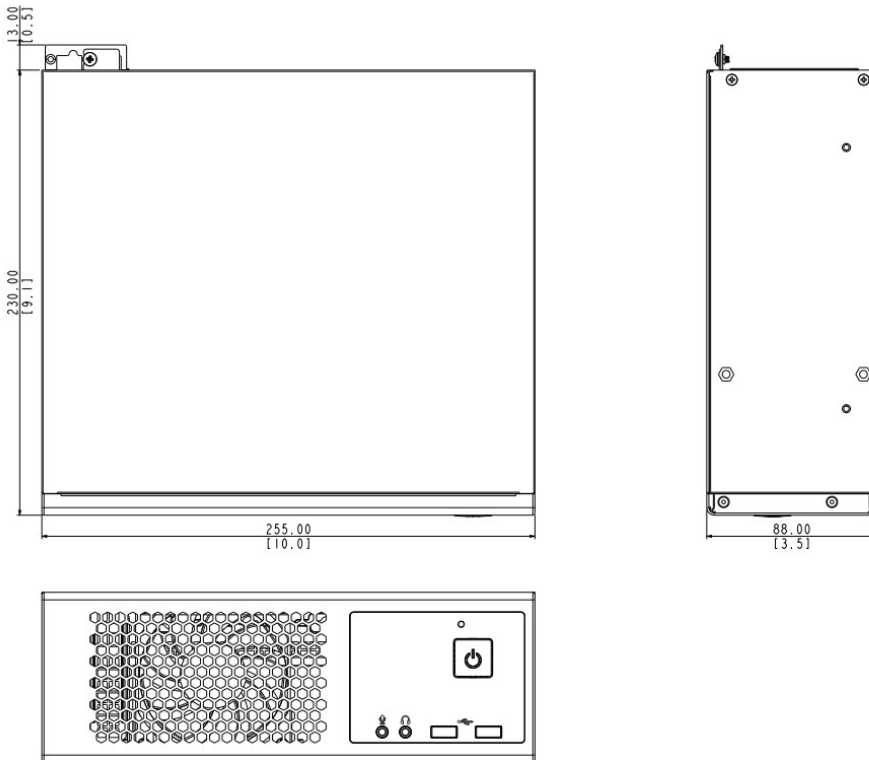

Unit: mm [inch]

▶ Related Products

Network & Storage Peripherals - Hard Disk

PHDD-4E12



M.2 256G System drive with Windows 10 for PCS-100