

PMAX-0706 Quick Installation Guide

PACKAGE CONTENTS

The carton should contain the following items:

- Junction box
- Hexagon wrench
- Screw pack x 2
- Rubber plug x2
- Cable gland
- Metal plate x 2
- Conduit gland
- Drill template



If any item is missing or damaged, please contact your local reseller for replacement.

USING THE JUNCTION BOX

1. Insert the camera cables through the hole on the Junction Box, then mount the camera onto the Junction Box.



2. Select the rubber plug and plate suitable for the thickness of the camera cable.



3. Attach the rubber plug through the cable. Then align and insert the rubber plug.



4. Insert the metal plate through the cable. Align and attach using the three (3) bundled screws to tighten and secure the rubber plug.

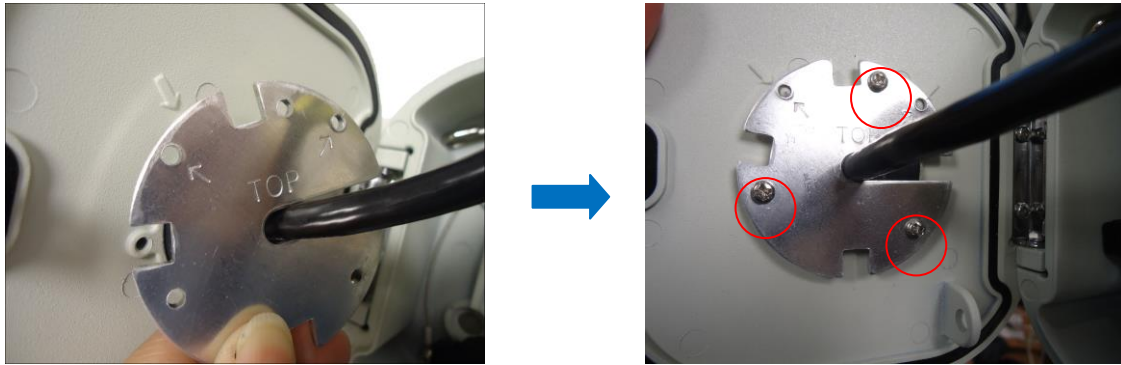

5. Attach the cable or conduit gland to the Junction Box. Route the network cable or any other cables through the gland.

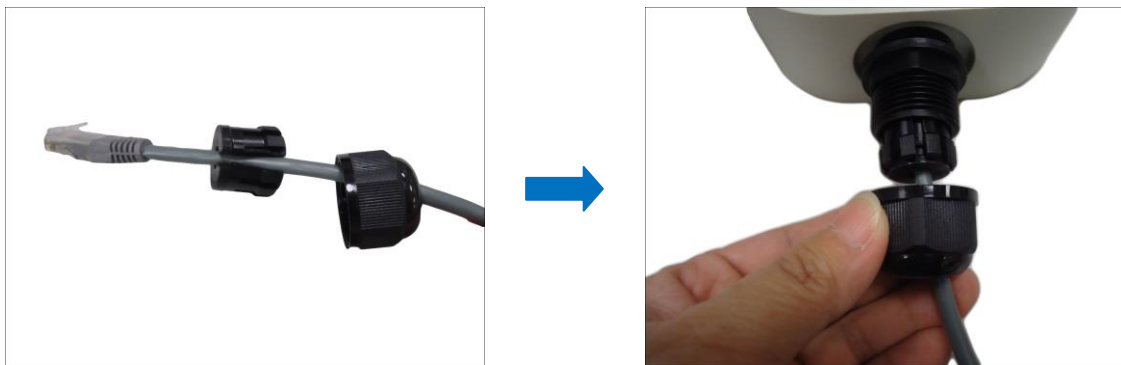

6. Connect the cables and close the Junction Box cover.

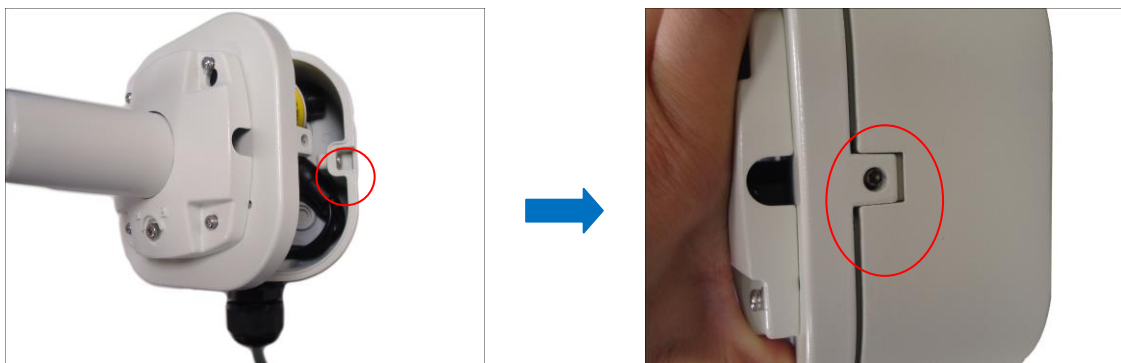

NOTE: DO NOT remove the screw attached to the Junction Box. Just close the cover over the screw.

7. Insert the bundled hexagon wrench through the cover screw hole and continuously turn the screw to the right until the cover is tightly locked.

