



# Digital Video Recorders

## Quick Guide

# 1. Indicators

The indicators may vary device model.

Indicator	Description
RUN(Operation)	<ul style="list-style-type: none"><li>Steady on: Normal.</li><li>Blinks: Starting up.</li></ul>
NET(Network)	Steady on: Connected to network.
CLOUD	Steady on: Connected to cloud server.
HD(Hard disk)	<ul style="list-style-type: none"><li>Steady on: No disk, or disk is abnormal.</li><li>Blink: Normal, reading/writing data.</li></ul>

# 2. Interfaces

The following figures show the device appearance. The appearance may vary with device model.

- Type A

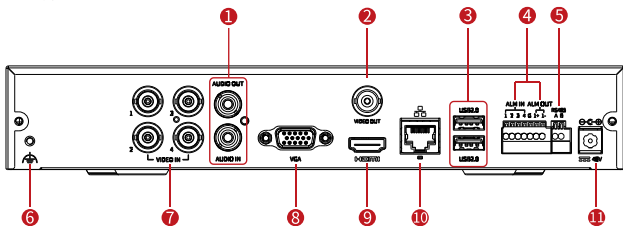

- Type B

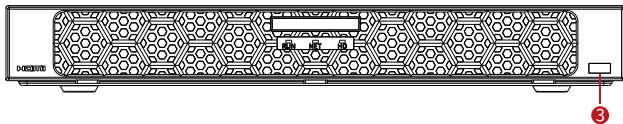

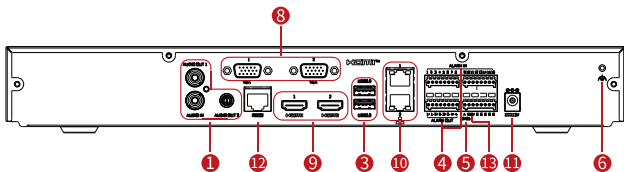

Interface	Description	Interface	Description
1.	Audio input/output	2.	Video output
3.	USB	4.	Alarm input/output
5.	RS485	6.	Grounding
7.	Video input	8.	VGA output
9.	HDMI output	10.	Network
11.	DC input	12.	RS232
13.	DC output		

## 3. Disk Installation

The illustrations are for reference only. The actual device may vary.

### 3.1 Check before Installation

#### 1 Check Device Components

Check against the packing list to make sure all components are complete.

#### 2 Check Tools

Please prepare the following tools:

- Phillips screwdriver
- Antistatic wrist strap or gloves

#### 3 Check Installation Site

The device must be installed indoors and the site must meet lightning protection and grounding requirements:

- The installation environment must meet lightning protection requirements. A appropriate lightning protection device can be used if necessary.

- The device is properly grounded through its grounding terminal.

## 3.2 HDD Installation



### CAUTION!

Be sure to disconnect the power before installation and wear antistatic gloves during installation.

1. Loosen the screws on the rear panel and side panel and remove the upper cover.

- Type A

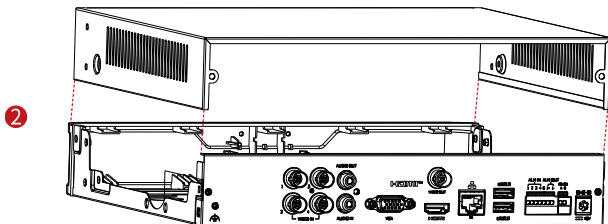
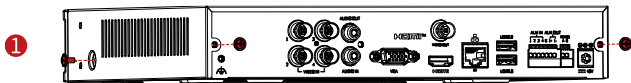

- Type B

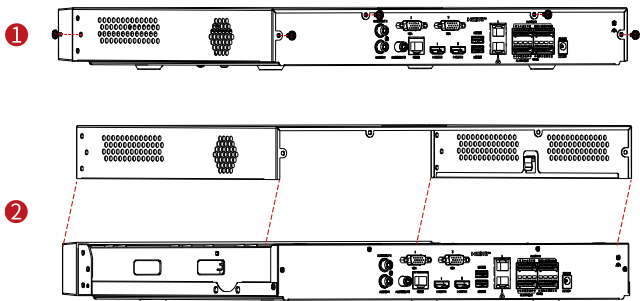

2. Insert the screws into the disk and tighten the screws halfway.

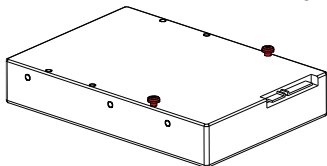

3. Slide the disk into place from A to B, and fix the screws to secure the hard disk.

● Type A

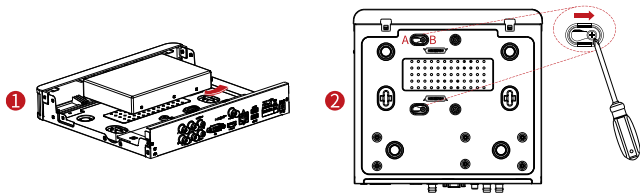

● Type B

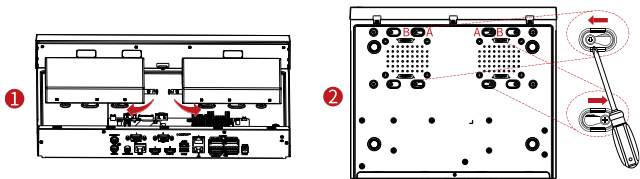

4. Connect the power cables and data cables.

- Type A

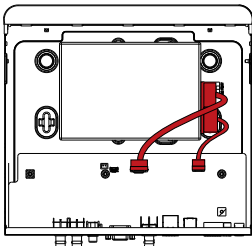

- Type B

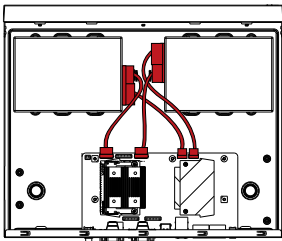

5. Put the cover back in place and tighten the screws.

## 3.3 Device Installation

You can install the device in a standard 19-inch rack or place it on a clean workbench.



### CAUTION!

Do not stack devices or put anything on the device, otherwise the device heat dissipation may be affected.

### 3.3.1 Install in a Rack



### CAUTION!

- Keep the rack away from vibration sources, such as generators.
- Make sure a tray is installed on the cabinet before rack installation. It is forbidden to hold the device by mounting brackets only.

1. Align the holes of the mounting brackets with holes on both sides of the device, and insert 4 screws to secure the brackets to the device using a Phillips screwdriver.

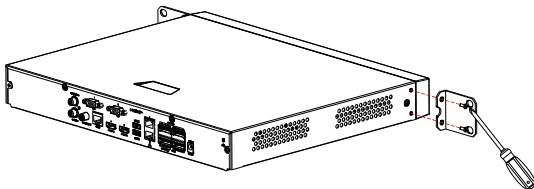

2. Select the desired installation position and secure the four supplied floating nuts to the square hole strips on both sides of the rack.

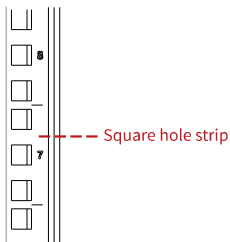

3. Align the mounting bracket holes with the floating nut holes, and place the device on the rack.

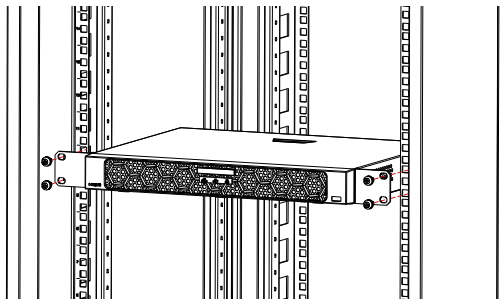

4. Insert the screws into the holes and tighten the screws using a screwdriver.

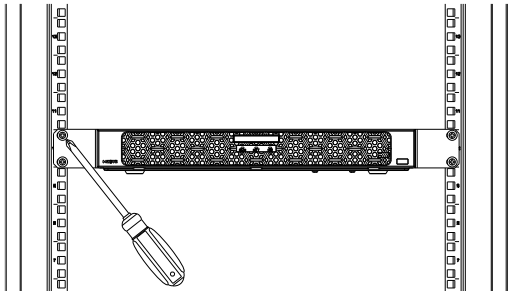

### 3.3.2 Place on a Workbench

Place the device on a clean workbench if a standard 19-inch rack is not available.

Make sure the following requirements are met:

- The workbench is strong enough to hold the device and cables.
- The workbench is well grounded and securely installed.
- Allow at least 30cm space at the front and back sides and at least 10cm space at the left and right sides of the device for heat dissipation.
- Do not stack devices or put anything on the device.

## 4. Connect Devices

1. Connect the device to a monitor with a VGA/HDMI cable (sold separately).
2. Connect a USB mouse to the device.
3. (For analog camera only) Connect the camera to a video input interface with a coaxial cable. Skip this step if you are connecting an IP camera.
4. Connect the network cable.



### NOTE!

Normally a network switch is used to connect the device and IP cameras with one network.

5. Connect power.

## 5. Startup

Make sure the installation and cable connection are correct. Connect power to start the device.

## 6. Web Login

Default IP address:

**192.168.1.30**

Default

username/password:

**admin/ 123456**

**Note:**

For security, please set a strong password of at least nine characters including uppercase and lowercase letters, digits, and special characters. You are strongly recommended to regularly change the device password and keep it secure to ensure that only authorized users can log in.

## 7. Add Cameras

### 7.1 Analog Camera

Please prepare a coaxial cable (sold separately). Connect BNC connectors to the camera and the device.



**NOTE!**

Please refer to PTZ descriptions for presets if the analog camera is connected to the PTZ via RS485.

---

### 7.2 IP Camera

Make sure the IP camera is connected to the network.

1. Go to Menu > Camera > Camera.
2. Click  to add the camera.

**NOTE!**

- To search a specified network segment, click **Search Segment**.
- Check the status of camera.  means the camera gets online successfully. If the status icon is grayed out, place your mouse cursor over the icon to view the cause of error. Click the edit button to modify if necessary.

## 8. Change Camera Type

The device can connect two IP cameras by default. To connect more IP cameras, go to **Menu > Camera > Camera > Camera Type**, and change camera type to digital. An analog camera cannot be connected when the camera type is set to digital.

## 9. Recording and Playback

### 9.1 Recording

- For analog camera: You need to manually enable the recording schedule for the camera (**Menu > Storage > Recording**).

**NOTE!**

When recording schedule is enabled, the device still records even when no analog camera is connected.

- For IP camera: A 24/7 recording schedule is enable by default for all IP cameras. You may edit recording time and type at **Menu > Storage > Recording Schedule**.

### 9.2 Playback

Right-click a preview window and then choose **Playback** to view video recorded on the current day.

## 10. Access Using a Web Browser

Access the device using a Web browser (e.g., Internet Explorer) from a connected computer.

1. Enter the device's IP address in the address bar and then press **Enter**. Install the plugin as prompted. Close all Web browsers when the installation starts.
2. Open the Web browser and log in with the correct username and password.

## 11. Access from Mobile App

Install the app on your mobile phone and sign up for a cloud account. For details, please contact your dealer.

Connect your device to a router with Internet connection, and connect your mobile phone to the router's Wi-Fi network. Scan the QR code on the device using the mobile app to add the device.

## 12. Shutdown

Click **Menu > Shutdown**.



---

### **CAUTION!**

Do not disconnect power when the device is operating. A sudden power failure may cause device damage and loss of data.

---

# Disclaimer and Safety Warnings

## Copyright Statement

©2021-2025 Zhejiang Uniview Technologies Co., Ltd. All rights reserved.

No part of this manual may be copied, reproduced, translated or distributed in any form or by any means without prior consent in writing from Zhejiang Uniview Technologies Co., Ltd (referred to as Uniview or us hereafter).

The product described in this manual may contain proprietary software owned by Uniview and its possible licensors. Unless permitted by Uniview and its licensors, no one is allowed to copy, distribute, modify, abstract, decompile, disassemble, decrypt, reverse engineer, rent, transfer, or sublicense the software in any form by any means.

## Trademark Acknowledgements

 are trademarks or registered trademarks of Uniview.



The terms HDMI, HDMI High-Definition Multimedia Interface, HDMI Trade dress and the HDMI Logos are trademarks or registered trademarks of HDMI Licensing Administrator, Inc.

All other trademarks, products, services and companies in this manual or the product described in this manual are the property of their respective owners.

## Export Compliance Statement

Uniview complies with applicable export control laws and regulations worldwide, including that of the People's Republic of China and the United States, and abides by relevant regulations relating to the export, re-export and transfer of hardware, software and technology. Regarding the product described in this manual, Uniview asks you to fully understand and strictly abide by the applicable export laws and regulations worldwide.

## EU Authorised Representative

UNV Technology EUROPE B.V. Treubstraat 1, 2288 EG, Rijswijk, Netherlands.

If you have any feedback, please contact us at [service@uniview.com](mailto:service@uniview.com).

## Privacy Protection Reminder

Uniview complies with appropriate privacy protection laws and is committed to protecting user privacy. You may want to read our full privacy policy at our website and get to know the ways we process your personal information. Please be aware, using the product described in this manual may involve the collection of personal information such as face, fingerprint, license plate number, email, phone number, GPS. Please abide by your local laws and regulations while using the product.

## About This Manual

- This manual is intended for multiple product models, and the photos, illustrations, descriptions, etc. in this manual may be different from the actual appearances, functions, features, etc. of the product.
- This manual is intended for multiple software versions, and the illustrations and descriptions in this manual may be different from the actual GUI and functions of the software.
- Despite our best efforts, technical or typographical errors may exist in this manual. Uniview cannot be held responsible for any such errors and reserves the right to change the manual without prior notice.
- Users are fully responsible for the damages and losses that arise due to improper operation.
- Uniview reserves the right to change any information in this manual without any prior notice or indication. Due to such reasons as product version upgrade or regulatory requirement of relevant regions, this manual will be periodically updated.

## Disclaimer of Liability

- To the extent allowed by applicable law, in no event will Uniview be liable for any special, incidental, indirect, consequential damages, nor for any loss of profits, data, and documents.
- The product described in this manual is provided on an "as is" basis. Unless required by applicable law, this manual is only for informational purpose, and all statements, information, and recommendations in this manual are presented without warranty of any kind, expressed or implied, including, but not limited to, merchantability, satisfaction with quality, fitness for a particular purpose, and noninfringement.
- Users must assume total responsibility and all risks for connecting the product to the Internet, including, but not limited to, network attack, hacking, and virus. Uniview strongly recommends that users take all necessary measures to enhance the protection of network, device, data and personal information. Uniview disclaims any liability related thereto but will readily provide necessary security related support.
- To the extent not prohibited by applicable law, in no event will Uniview and its employees, licensors, subsidiary, affiliates be liable for results arising out of using or inability to use the product or service, including, not limited to, loss of profits and any other commercial damages or losses, loss of data, procurement of substitute goods or services; property damage, personal injury, business interruption, loss of business information, or any special, direct, indirect, incidental, consequential, pecuniary, coverage, exemplary, subsidiary losses, however caused and on any theory of liability, whether in contract, strict liability or tort (including negligence or otherwise) in any way out of the use of the product, even if Uniview has been advised of the possibility of such damages (other than as may be required by applicable law in cases involving personal injury, incidental or subsidiary damage).
- To the extent allowed by applicable law, in no event shall Uniview's total liability to you for all damages for the product described in this manual (other than as may be required by applicable law in cases involving personal injury) exceed the amount of money that you have paid for the product.

## Network Security

**Please take all necessary measures to enhance network security for your device.**

The following are necessary measures for the network security of your device:

- **Change default password and set strong password:** You are strongly recommended to change the default password after your first login and set a strong password of at least nine characters including all three elements: digits, letters and special characters.
- **Keep firmware up to date:** It is recommended that your device is always upgraded to the latest version for the latest functions and better security. Visit Uniview's official website or contact your local dealer for the latest firmware.

The following are recommendations for enhancing network security of your device:

- **Change password regularly:** Change your device password on a regular basis and keep the password safe. Make sure only the authorized user can log in to the device.
- **Enable HTTPS/SSL:** Use SSL certificate to encrypt HTTP communications and ensure data security.
- **Enable IP address filtering:** Allow access only from the specified IP addresses.
- **Minimum port mapping:** Configure your router or firewall to open a minimum set of ports to the WAN and keep only the necessary port mappings. Never set the device as the DMZ host or configure a full cone NAT.
- **Disable the automatic login and save password features:** If multiple users have access to your computer, it is recommended that you disable these features to prevent unauthorized access.
- **Choose username and password discretely:** Avoid using the username and password of your social media, bank, email account, etc, as the username and password of your device, in case your social media, bank and email account information is leaked.
- **Restrict user permissions:** If more than one user needs access to your system, make sure each user is granted only the necessary permissions.
- **Disable UPnP:** When UPnP is enabled, the router will automatically map internal ports, and the system will automatically forward port data, which results in the risks of data leakage. Therefore, it is recommended to disable UPnP if HTTP and TCP port mapping have been enabled manually on your router.
- **SNMP:** Disable SNMP if you do not use it. If you do use it, then SNMPv3 is recommended.
- **Multicast:** Multicast is intended to transmit video to multiple devices. If you do not use this function, it is recommended you disable multicast on your network.
- **Check logs:** Check your device logs regularly to detect unauthorized access or abnormal operations.
- **Physical protection:** Keep the device in a locked room or cabinet to prevent unauthorized physical access.
- **Isolate video surveillance network:** Isolating your video surveillance network with other service networks helps prevent unauthorized access to devices in your security system from other service networks.

#### Learn More

You may also obtain security information under Security Response Center at Uniview's official website.

## Safety Warnings

The device must be installed, serviced and maintained by a trained professional with necessary safety knowledge and skills. Before you start using the device, please read through this guide carefully and make sure all applicable requirements are met to avoid danger and loss of property.

### **Storage, Transportation, and Use**

- Store or use the device in a proper environment that meets environmental requirements, including and not limited to, temperature, humidity, dust, corrosive gases, electromagnetic radiation, etc.
- Make sure the device is securely installed or placed on a flat surface to prevent falling.
- Unless otherwise specified, do not stack devices.
- Ensure good ventilation in the operating environment. Do not cover the vents on the device. Allow adequate space for ventilation.
- Protect the device from liquid of any kind.
- Make sure the power supply provides a stable voltage that meets the power requirements of the device. Make sure the power supply's output power exceeds the total maximum power of all the connected devices.
- Verify that the device is properly installed before connecting it to power.
- Do not remove the seal from the device body without consulting Uniview first. Do not attempt to service the product yourself. Contact a trained professional for maintenance.
- Always disconnect the device from power before attempting to move the device.
- Take proper waterproof measures in accordance with requirements before using the device outdoors.

### **Power Requirements**

- Install and use the device in strict accordance with your local electrical safety regulations.
- Use a UL certified power supply that meets LPS requirements if an adapter is used.
- Use the recommended cordset (power cord) in accordance with the specified ratings.
- Only use the power adapter supplied with your device.
- Use a mains socket outlet with a protective earthing (grounding) connection.
- Ground your device properly if the device is intended to be grounded.

### **Battery Use Caution**

- When battery is used, avoid:
  - Extremely high or low temperature and air pressure during use, storage and transportation.
  - Battery replacement.
- Use the battery properly. Improper use of the battery such as the following may cause risks of fire, explosion or leakage of flammable liquid or gas.
  - Replace battery with an incorrect type.
  - Dispose of a battery into fire or a hot oven, or mechanically crushing or cutting of a battery.
- Dispose of the used battery according to your local regulations or the battery manufacturer's instructions.

### **Avertissement de l'utilisation de la batterie**

- Lorsque utiliser la batterie, évitez:
  - Température et pression d'air extrêmement élevées ou basses pendant l'utilisation, le stockage et le transport.
  - Remplacement de la batterie.

- Utilisez la batterie correctement. Mauvaise utilisation de la batterie comme celles mentionnées ici, peut entraîner des risques d'incendie, d'explosion ou de fuite liquide de gaz inflammables.
  - Remplacer la batterie par un type incorrect.
  - Disposer d'une batterie dans le feu ou un four chaud, écraser mécaniquement ou couper la batterie.
- Disposer la batterie utilisée conformément à vos règlements locaux ou aux instructions du fabricant de la batterie.
- **Personal safety warnings:**
  - Chemical Burn Hazard. This product contains a coin cell battery. Do NOT ingest the battery. It can cause severe internal burns and lead to death.
  - Keep new and used batteries away from children.
  - If the battery compartment does not close securely, stop using the product and keep it away from children.
  - If you think batteries might have been swallowed or placed inside any part of the body, seek immediate medical attention.
- **Avertissements de sécurité personnelle:**
  - Risque de brûlure chimique. Ce produit contient une batterie de cellules. N'ingérer pas la batterie. Si la batterie de cellule est avalée, elle peut causer de graves brûlures internes en seulement 2 heures et peut entraîner la mort.
  - Gardez les batteries nouvelles ou utilisées à l'écart des enfants.
  - Si le compartiment de la batterie ne se ferme pas en toute sécurité, cessez d'utiliser le produit et gardez-le à l'écart des enfants.
  - Si vous pensez que des piles ont pu être avalées ou placées à l'intérieur d'une partie du corps, consultez immédiatement un médecin.

## Regulatory Compliance

### FCC Statements

This device complies with Part 15 of the FCC Rules. Operation is subject to the following two conditions: (1) this device may not cause harmful interference, and (2) this device must accept any interference received, including interference that may cause undesired operation.

Visit [https://global.uniview.com/Support/Download\\_Center/Product\\_Installation/Declaration/](https://global.uniview.com/Support/Download_Center/Product_Installation/Declaration/) for SDoC.

**Caution:** The user is cautioned that changes or modifications not expressly approved by the party responsible for compliance could void the user's authority to operate the equipment.

**NOTE:** This equipment has been tested and found to comply with the limits for a Class A digital device, pursuant to part 15 of the FCC Rules. These limits are designed to provide reasonable protection against harmful interference when the equipment is operated in a commercial environment. This equipment generates, uses, and can radiate radio frequency energy and, if not installed and used in accordance with the instruction manual, may cause harmful interference to radio communications. Operation of this equipment in a residential area is likely to cause harmful interference in which case the user will be required to correct the interference at his own expense.

#### LVD/EMC Directive



This product complies with the European Low Voltage Directive 2014/35/EU and EMC Directive 2014/30/EU.

#### WEEE Directive-2012/19/EU



The product this manual refers to is covered by the Waste Electrical & Electronic Equipment (WEEE) Directive and must be disposed of in a responsible manner.

#### Battery Regulation- (EU) 2023/1542



Battery in the product complies with the European Battery Regulation (EU) 2023/1542. For proper recycling, return the battery to your supplier or to a designated collection point.