

# R72FT-31



- Access Control with Card + Face Recognition + Temperature Detection
- 7" LCD Color Touch Screen
- Wiegand Reader and Controller
- Bundle with 6000 Face Database
- Built-in MIFARE Card Reading Module
- Not available in the USA

## ► Specifications

### Device

|                         |   |
|-------------------------|---|
| Product Type            | Reader and Controller   |
| Device Type             | Access Controller RFID Reader Face Reader   |
| Product Application     | Access Control with Card + Face Recognition + Temperature Detection   |
| Application Environment | Indoor  |
| Description             | Thermal and Optical 2MP Mifare LCD Card Face Recognition Wiegand Reader and Controller with Bundle 6,000 Card Database / 6,000 Face Database. |
| Image Sensor            | Progressive Scan CMOS + Thermal sensor  |
| Effective Pixels        | Thermal: 120(H) X 160(V)  |
| LCD Screen              | 7" Color Touch Screen; Resolution: 1024 x 600   |

### Lens

|                  |             |
|------------------|-------------|
| Number of Lenses | 2 Lenses    |
| Focal Length     | Fixed focal |

### Video

|                    |   |
|--------------------|---|
| Built-in Analytics | Face Recognition, Human Temperature Detection, RFID Recognition |
|--------------------|---|

### Network

|               |  |
|---------------|--|
| Ethernet Port | 1 x Ethernet (10/100/1000 Base-T), RJ-45 connector |
|---------------|--|

**Video Analytics**

|                           |             |
|---------------------------|-------------|
| Face Recognition Distance | 0.3m - 1.8m |
|---------------------------|-------------|

**Temperature Measurement**

|                                |                            |
|--------------------------------|----------------------------|
| Temperature Range              | 30°C ~ 45°C (86°F ~ 113°F) |
| Temperature Detection Distance | 0.3m ~ 1.8m                |

**Event**

|           |         |
|-----------|---------|
| Event Log | 100,000 |
|-----------|---------|

**System**

|                  |       |
|------------------|-------|
| Operating System | Linux |
|------------------|-------|

**RFID Card**

|                         |            |
|-------------------------|------------|
| Communication Frequency | 13.56 MHz  |
| RFID Standard           | ISO 14443A |
| Reading Range           | 0-5cm      |
| RFID Options            | MIFARE     |

**Storage**

|                                |   |
|--------------------------------|---|
| User Database                  | Card Capacity: 6000 Face Picture Capacity: 6000 |
| Face Only Detection User Limit | 6000  |

**Interface**

|                      |                                   |
|----------------------|-----------------------------------|
| Serial Port          | 1 x RS-485                        |
| Digital Input/Output | 2/1                               |
| Digital Input        | Door contact x 1, Exit Button x 1 |
| Relay Output         | Door lock x 1                     |
| External Reader      | Wiegand x 1                       |

**General**

|                       |  |
|-----------------------|--|
| Power Source          | DC 12V, 2 A  |
| Weight                | 990g (2.183lb)   |
| Dimensions            | (W x H x D): 117mm x 285mm x 35mm (4.61" x 11.22" x 1.38")   |
| Operating Temperature | 0°C ~ 50°C (32°F ~ 122°F)  |
| Operating Humidity    | 10% - 95% RH   |
| Warranty              | 1 Year(s). For extended warranty offering, see <a href="http://www.acti.com/support/warranty">http://www.acti.com/support/warranty</a> |

► Photo Indication

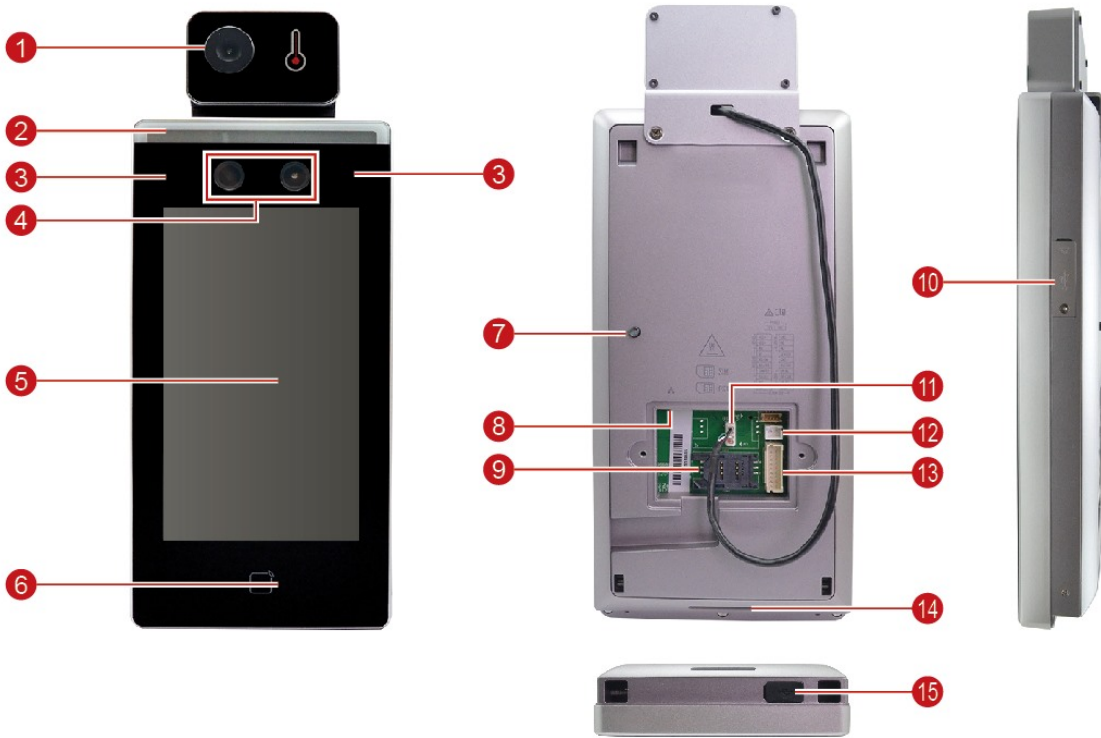

► Dimension Diagram

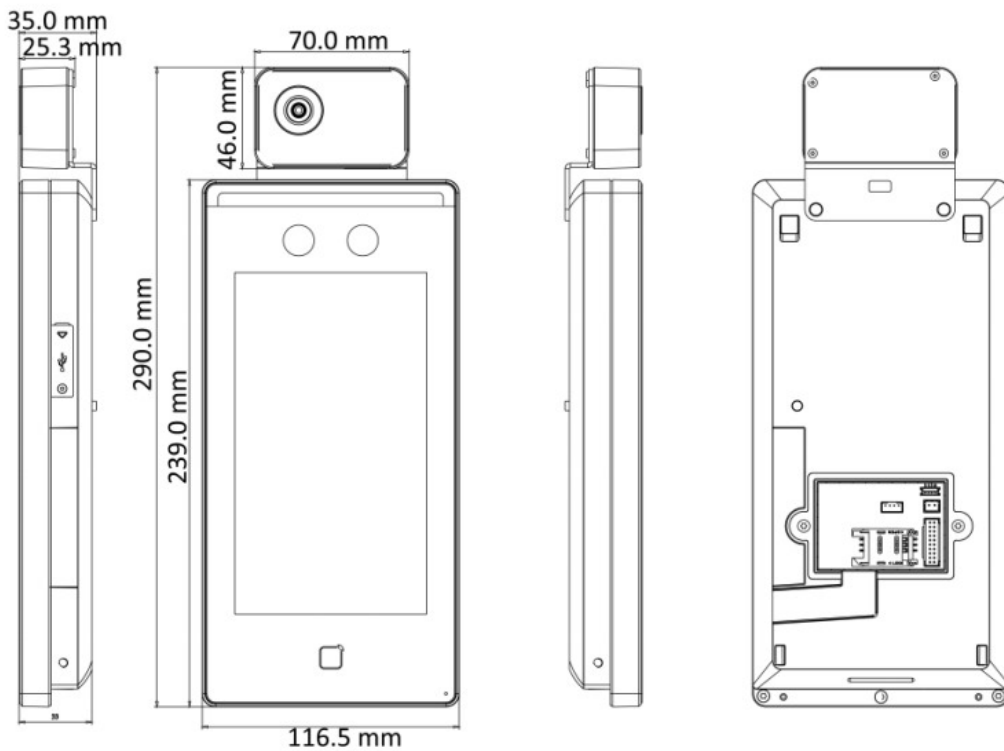

Unit: mm [inch]

## ▶ Related Products

### Access Control System - Access Card

PACD-0004



RFID Card Mifare 13.56 MHz

### Power Supply Accessories - Power Adapter

PPBX-0016



Power Adapter AC 100~240V (12V/5A Output), with universal connectors for R7 series