

“Waterproof installation” without waterproof joint

Waterproof and Connect the Cable(s)

The camera and the pre-installed network cable, “pigtail”, are resistant to salt, water, weak acid, alcohol, oil, grease and other common solvents. However, users must ensure that the cable connection and the network side cable itself are also protected from different environmental factors.

Using Waterproof Tape

Regardless of the shape of the camera cable connector, the simplest way to waterproof to connection is by using the waterproof tape. Connect an Ethernet cable from the network side to the Ethernet port of the camera and wrap the connection with waterproof tape to complete the installation.

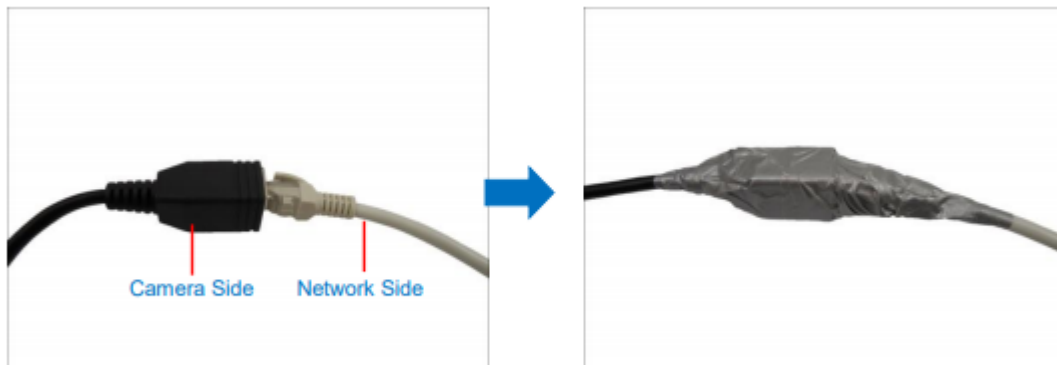

NOTES: on using Ethernet cables: For outdoor installations, it is recommended to use exterior-grade Ethernet cables (CAT5/CAT5e/CAT6); ordinary Ethernet cables are only designed for indoor use and may deteriorate quickly when exposed to outdoor elements. Exterior-grade Ethernet cables are waterproof and do not require a conduit.

“Waterproof installation with waterproof joint”

Using the Cable Gland

This section describes how to waterproof the cable-out or “pigtail” of camera using the bundled cable gland. Before connection, prepare an exterior-grade Ethernet cable with RJ-45 connector (without sleeve). Perform the following to waterproof the “pigtail” using the cable gland:

1. Attach the washer to the Ethernet connector of the camera.



2. Detach the clamping nut and sealing insert from the gland body:

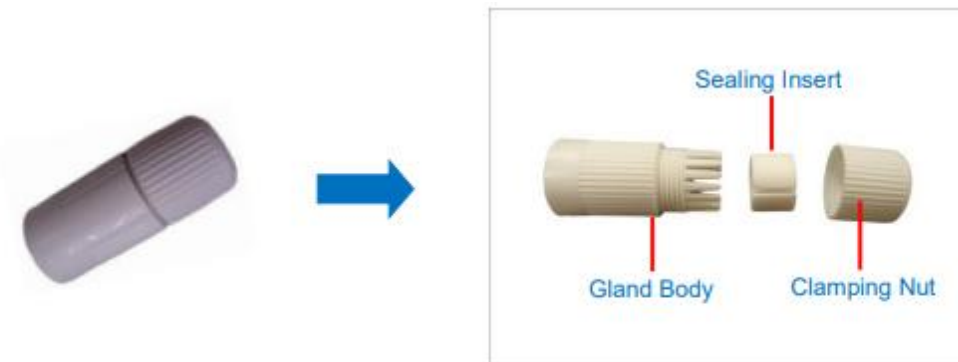

3. Insert the clamping nut into the Ethernet cable.



4. Insert the sealing insert through the Ethernet cable.



5. Insert the cable through the gland body.

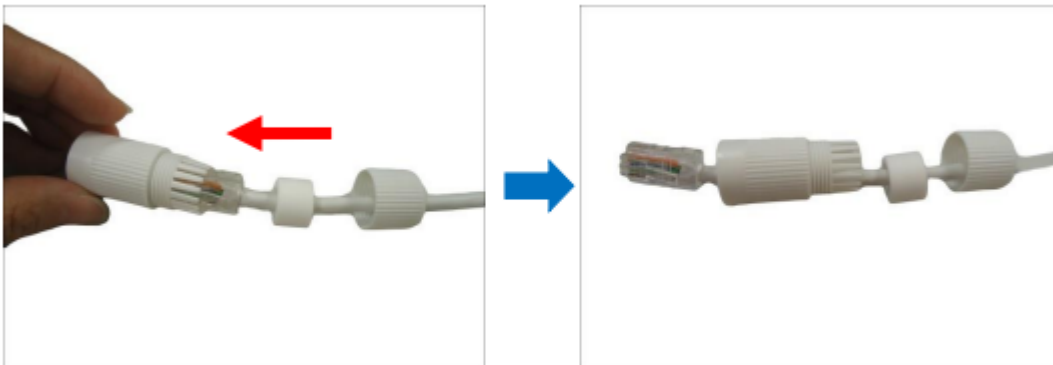

6. Push the sealing insert into the gland body.



7. Connect the RJ-45 connector to the camera connector.

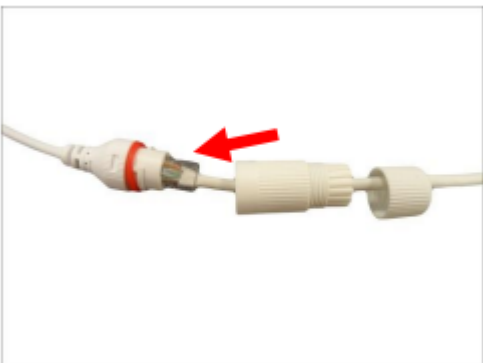

8. Attach the gland body to the camera connector.

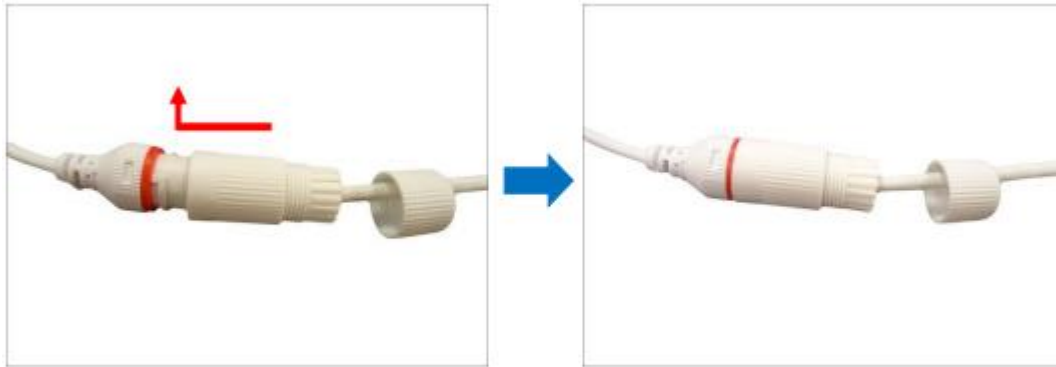

9. Attach the clamping nut to the gland body to complete the cable solution.

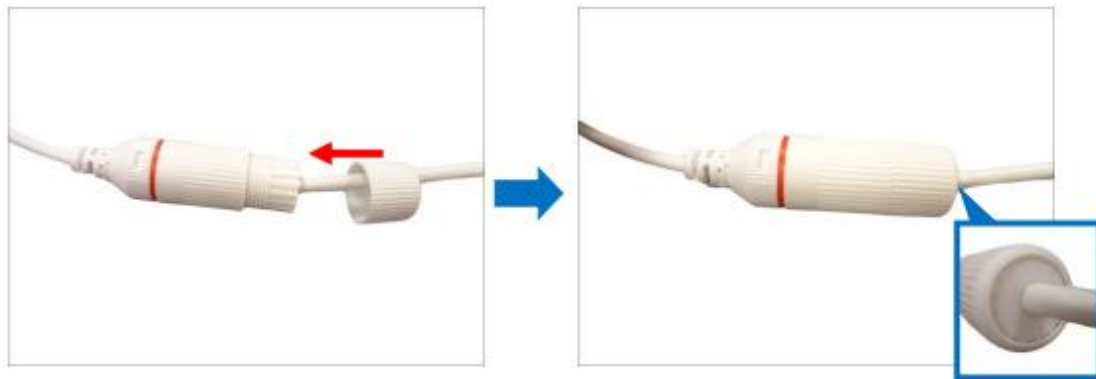

NOTE: Make sure the clamping nut is tightly attached to the cable gland body and the sealing insert is squeezed tightly

Waterproof Solution with Naked Cable

This section describes the procedures in using the bundled cable gland and an exterior-grade Ethernet cable.

1. Disassemble the cable gland as shown below:



2. Insert the clamping nut into the Ethernet cable.



3. Insert the sealing insert with claw

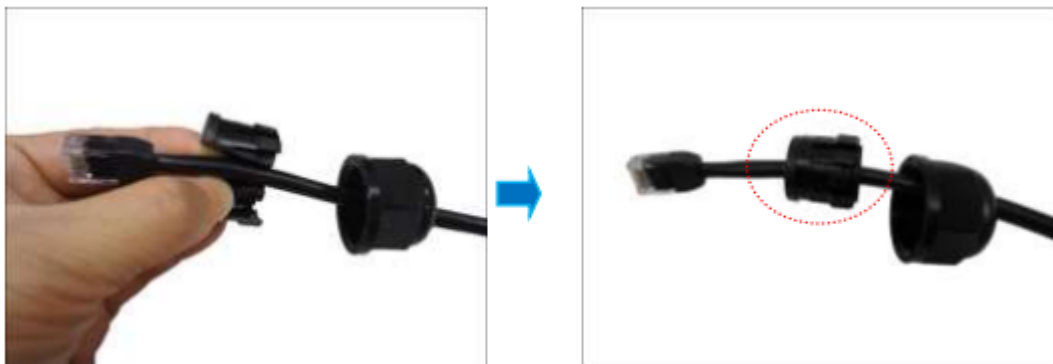

4. Attach the cable gland body to the hole of the camera.



Attach to Camera Side Hole

Or



Attach to Camera Bottom Hole

5. If the cable will be routed along the surface, pull the network cable through the side conduit hole



If the cable will pass through the surface, pull the network cable through the bottom conduit hole.



6. Insert the sealing insert with claw into the cable gland body and then attach the clamping nut to complete the cable solution. Same procedures apply to cable passing the surface or along the surface.



NOTE: Make sure the clamping nut is tightly attached to the cable gland body and the sealing insert is squeezed tightly.

7. Connect the network cable to the Ethernet port of the camera.



Waterproof Solution with Conduit

This section describes the procedures to waterproof the cabling connections using the bundled conduit gland and flexible conduit. This is the recommended solution if an exterior-grade Ethernet cable is not available or when other cables, such as power adapter, DI/DO devices, etc., will be connected to the camera.

1. Prepare the following materials for waterproof installation:

Conduit Gland (included in the camera package)	Flexible Conduit 1/2" Trade size (not included in the package)
 <p data-bbox="336 920 711 949">For use with 1/2" flexible conduit</p>	
Network Cable CAT 5 or CAT 6 (not included in the package)	
	

2. Disassemble the bundled conduit gland as shown below:



NOTE: In this installation, the conduit gland body can be securely attached to the mount kit; therefore the use of lock nut is not necessary. Please set the lock nut aside.

3. Pull the network cable through the flex conduit. If connecting other input/output devices or an external power adapter, pull the cables through the flex conduit without connectors. The terminal blocks will be attached once the cables pass through the camera hole later.



4. Insert the clamping nut through the flex conduit.



5. Insert the sealing insert and attach it at the end of the flex conduit.



6. Screw the conduit gland body to the conduit hole of the camera.



Attach to Side Conduit Hole

Or



Attach to Bottom Conduit Hole

7. If the cable(s) will be routed along the surface, skip this step. If the cable will pass through the surface, do the following:

a. Pull the network cable through the bottom conduit hole.



b. Insert the sealing insert into the conduit gland body and then attach the clamping nut as tightly as possible to complete the cable solution

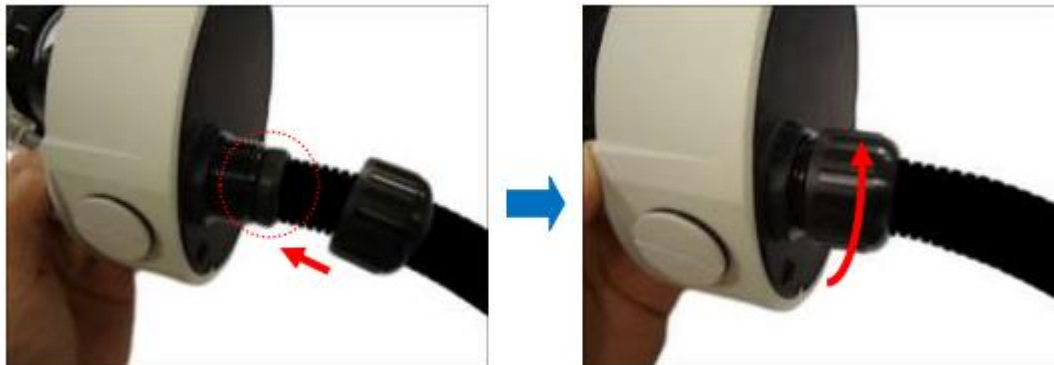

8. If only the network cable will be connected, connect the network cable to the Ethernet port of the camera at this point.