

Z721

4MP Deep Learning AI LightGuard f2.8mm Outdoor Fixed Dome with IR LED 30m, WDR 135dB , M12



- 4 Megapixel, f2.8mm Fixed Dome
- Weatherproof (IP67), Vandal proof (IK10), Vibration proof (EN50155)
- Built-in Analytics
- Event trigger, response and notification

► Specifications

Product Profile

Product Type	Fixed Dome
Application Environment	Outdoor
Maximum Resolution	4MP
Image Sensor	Progressive Scan CMOS
Sensor Size	1/3 "
Day / Night	Yes
Low Light Sensitivity	Extreme
LightGuard	Yes
Minimum Illumination	Color: 0.002 lux at F1.6 (AGC on); B/W: 0 lux (IR LED on)
Mechanical IR Cut Filter	Yes
IR LED	Adaptive IR LED (850 nm)
IR Working Distance	30m
Electronic Shutter	1-1/100000 second (manual mode); 1-1/100000 second (auto mode)
S/N Ratio	75 dB

Lens	
Focal Length	Fixed focal, f2.8mm
Aperture	F1.6
Horizontal Viewing Angle	101.1°
Vertical Viewing Angle	55.3°
Viewing Angle Adjustment	Pan: 0°-90°, Tilt: 0°-68°, Rotation: 0°-360°

Video	
Compression	H.265 Adaptive Stream (equivalent to Zip or Smart Stream or H.265+), H.264 Adaptive Stream (equivalent to Zip or Smart Stream or H.264+), MJPEG
Maximum Frame Rate vs. Resolution	30 fps at 2688 x 1520 30 fps at 2560 x 1440 30 fps at 2304 x 1296 30 fps at 1920 x 1080 30 fps at 1280 x 720 30 fps at 720 x 576 30 fps at 640 x 360 30 fps at 704 x 288 30 fps at 352 x 288
Multi-Streaming	Simultaneous triple streams
Digital Noise Reduction	2D + 3D DNR
Wide Dynamic Range	Extreme WDR (135 dB)
Image Orientation	Flip, Mirror, Rotation (Corridor mode)(±90°, 180°)
Image Enhancement	White Balance, Backlight compensation (BLC), Defogging
Privacy Mask	4 configurable regions
Text Overlay	Yes
Built-in Analytics	Smart Intrusion Protection, Smart Motion Detection (People Detection, Vehicle Detection), Face Detection, People Detection, Vehicle Detection, People Line Crossing Detection, People Enter Area Detection, People Exit Area Detection, Vehicle Line Crossing Detection, Vehicle Intrusion Detection, Vehicle Exit Area Detection, Tampering Detection, People Counting, Crowd Detection

Analytics	
Deep Learning AI	2.0

Audio	
Audio Type	2-way, Built-in Microphone, Line-in, Line-out

Network	
Network Protocol & Service	IPv4, IPv6, TCP, UDP, DHCP, PPPoE, HTTP, HTTPS, DNS, DDNS, NTP, RTP, RTSP, RTCP, RTMP, SMTP, FTP, IGMP, ICMP, ARP, Bonjour, UPnP, SNMP, QoS, SSL/TLS, IEEE 802.1X
Ethernet Port	1 x Ethernet (10/100 Base-T), M12 connector
Maximum User Connections	32
Security	IP address filtering, HTTPS encryption, Password protected user level

Event	
Event Trigger	Video motion detection, Sound detection, Intelligent event detection
Event Response	E-mail notification with snapshots, Save video or snapshot to storage, Upload snapshot to FTP server

Integration	
ONVIF Compliant	Yes, Profile S, Profile G, Profile T, Profile M

Web Browser | IE 11, Microsoft Edge, Google Chrome, Firefox

General

Power Source	DC 12V +/- 25%, PoE (IEEE802.3af)
Power Consumption	6 W (DC)
Dimensions	(Ø x H): 110mm x 61mm (4.3" x 2.4")
Environmental Casing	Weatherproof (IP67), Vandal proof (IK10), Vibration proof (EN50155)
Corrosion Protection	Optional for project request. Chassis corrosion resistance at the seashore approximately 2-3 years.
Operating Temperature	-30°C ~ 60°C (-22°F ~ 140°F)
Operating Humidity	≤95% RH, non-condensing
Surge Protection	4KV
Approvals	CE Class A, FCC Class A, IP67, IK10, EN50155
Color	White
Material	Metal
Real-time Clock (RTC)	Yes
Warranty	2 Year(s). For extended warranty offering, see http://www.acti.com/support/warranty

► Photo Indication



- 1 Built-in Microphone
- 2 Audio Input / Output
- 3 Ethernet Port
- 4 DC 12V Power Input



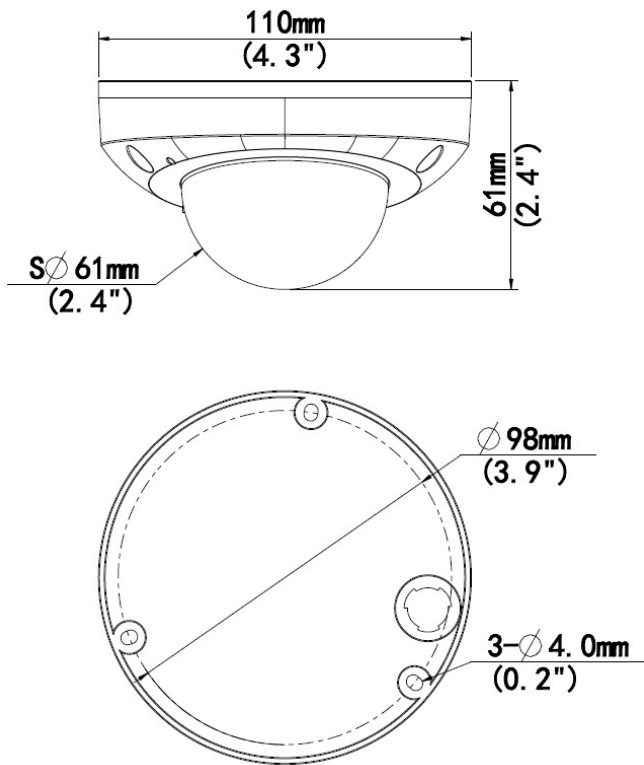





► Dimension Diagram



Unit: mm [inch]

▶ Related Products

Mounting Accessories - Camera Mount

PMAX-0128		Pendant Mount (for Z5x, Z724, Z85, Z86, Z87, Z810, Z972, Q550)
PMAX-0134		Extension Tube, 200 mm (for Z5x, Z724, Z85, Z86, Z87, Z810, Z972, Q550)
PMAX-0349		Wall Mount with Built-in Junction Box (for Z71, Z72)
PMAX-0365		Wall Mount with Built-in Junction Box (for Y7x, Z5x, Z7x, Z91x)
PMAX-0527		Pole Mount (for Z3x, Z4x, Z5x, Z724, Z8x, Z9x, Z972, A7x, Q550), supports 2.64" to 5" Poles
PMAX-0532		Pole Mount (for Z5x, Z724, Z8x, Z9x, Z972, A7X, Q550), supports 2.6" to 5" Poles
PMAX-0538		
PMAX-0712		Junction box (for Z91, Z92, Z94, Z95, Z97, Z98, Z714, Z77)

Note: Some mounting accessories may need additional accessories for installation. Please check www.acti.com/mountingselector for more information.