

Quick Installation Guide

INTRODUCTION

Model	Description
AW-IHH-0100	95W PoH/PoE output

PACKAGE CONTENTS

* 1x PoE injector	* 1x DIN rail bracket	* 2x wall mount brackets
* 1x Quick Installation Guide	* 1x 5-pin terminal block	

⚠ IMPORTANT:

1. Use CAT5 or 5e UTP/STP cables.
2. Always shut down the power source before connecting power wires.

CONNECTION

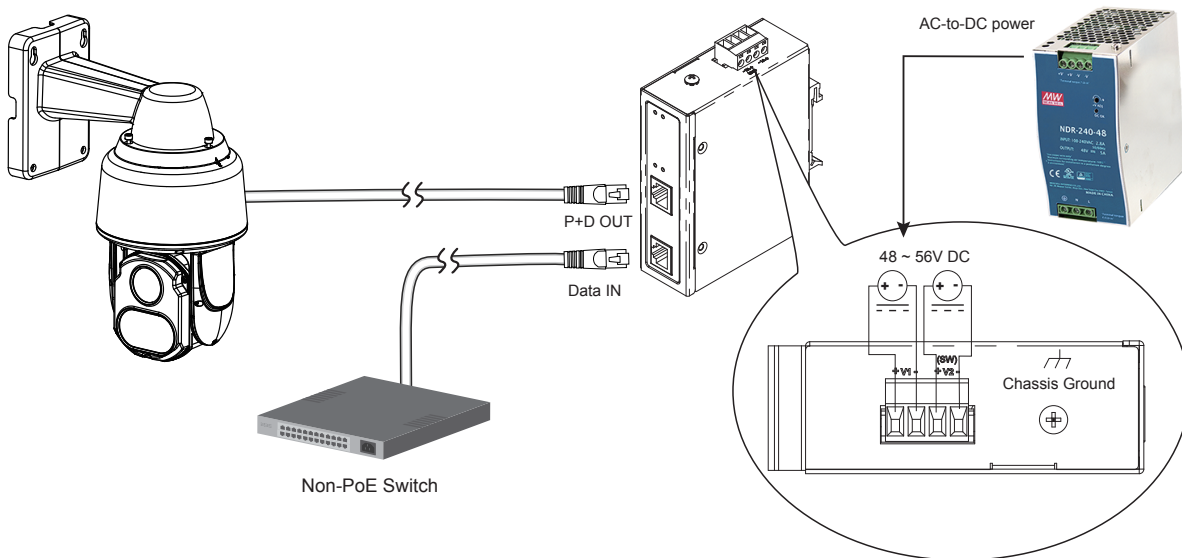

LEDs

AW-IHH-0100

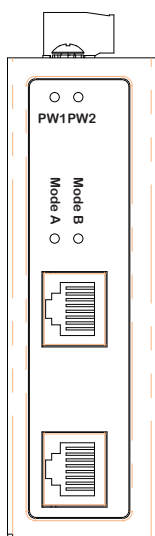

LED definitions:

PW1	Green ON: power good; OFF: power failed.
PW2	Green ON: power good; OFF: power failed.
Mode A	End span PD detected
Mode B	Mid span PD detected

All specifications are subject to change without notice.
Copyright © 2016 VIVOTEK INC. All rights reserved.